

SPECIFICATIONS AND DRAWING ARE SUBJECT TO CHANGE WITHOUT PRIOR NOTICE. TUBE CREATES X-RAY WHEN ENERGIZED. TUBE MAY CONTAIN BERYLLIUM PRODUCT.

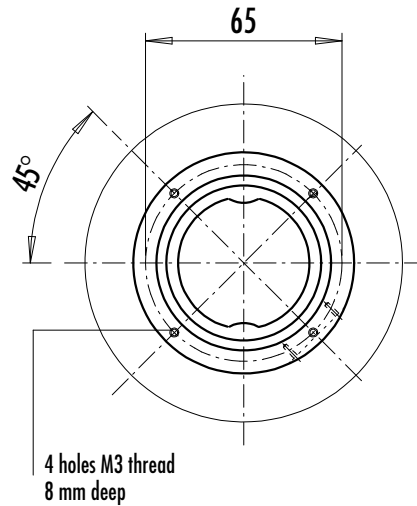
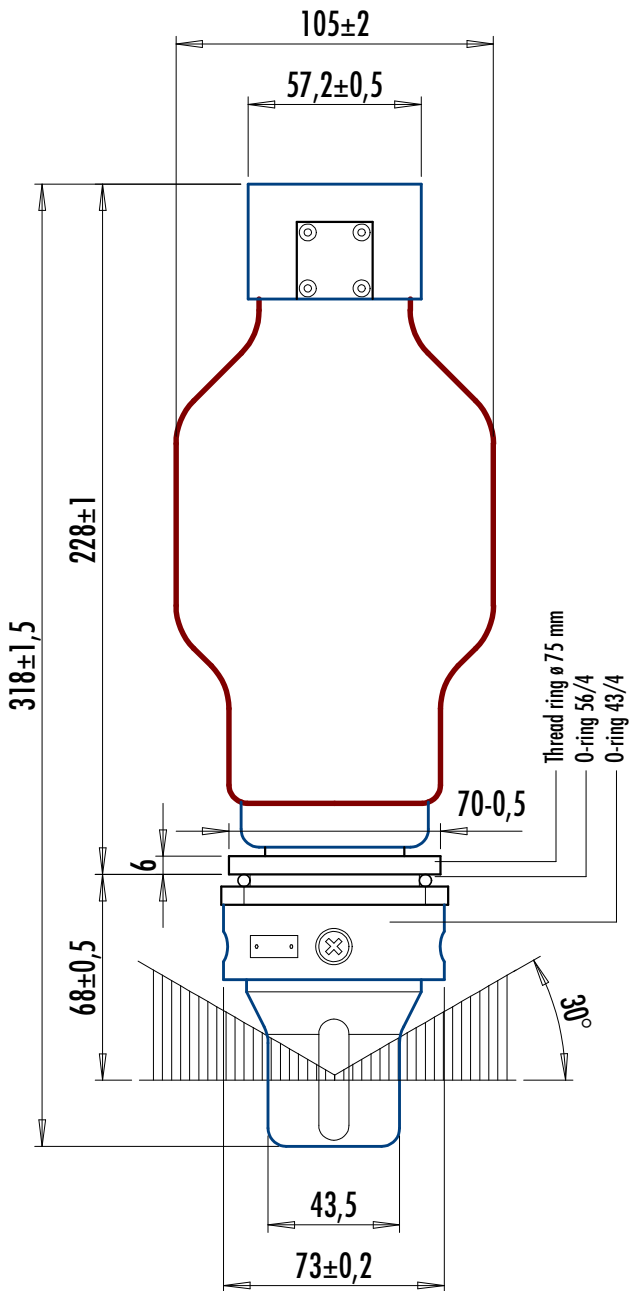

X-RAY INSERT 360° 160 kV, FLAT ANODE NICKEL WINDOW

tube voltage max.:	160 kV
tube current max.:	6 mA
(depends on cooling)	
tube power max.:	960 W
filament voltage ca.:	3,4 V
filament current:	$5,0 \pm 0,2$ A
nom. focal spot:	mm
inherent filtration:	0,6 mm Ni
anode angle:	0°
beam angle:	360°
frequency:	50-2000 Hz
cooling:	+2 l/min.

0893