

SPECIFICATIONS AND DRAWING ARE SUBJECT TO CHANGE WITHOUT PRIOR NOTICE. TUBE CREATES X-RAY WHEN ENERGIZED. TUBE MAY CONTAIN BERYLLIUM PRODUCT.

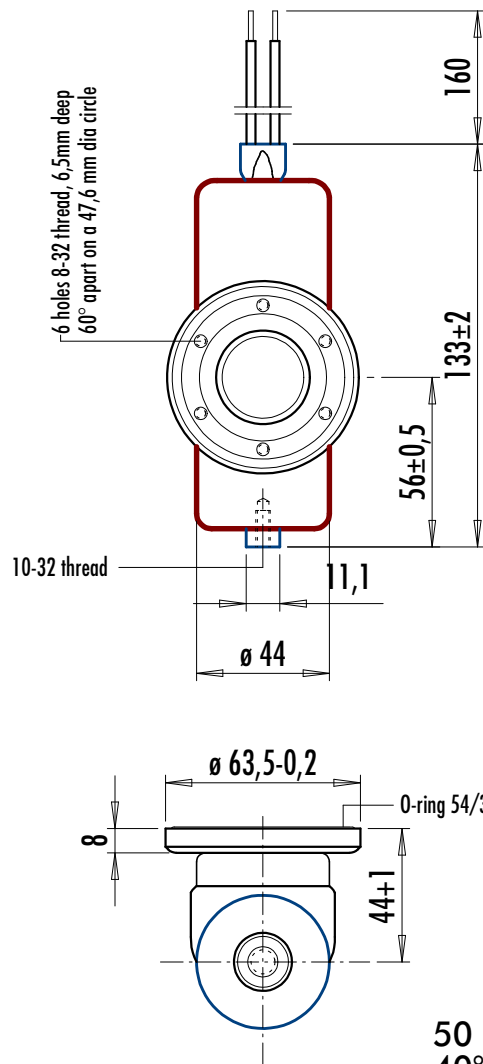

0997

**50 KV X-RAY INSERT  
40° DIRECTIONAL BEAM  
CENTRE BE-WINDOW**

### TUNGSTEN TARGET

OPTIONAL: Fe TARGET

tube voltage max.:	50 kV	nom. focal spot:	0,5 x 0,5 mm
tube current max.:	5 mA	inherent filtration:	0,8 mm Be
tube power max.:	250 W	anode angle:	25°
(depends on cooling)		beam angle:	40°
filament voltage ca.:	< 4 V	frequency:	50-60 Hz
filament current:	< 4 A	cooling:	oil, gas